

ORDER INFORMATION AND DIMENSION:

Circuits	Part No. (Matte tin-plated)	Dimension		
		A	B	C
2	3002P02 89V	NA	6.7	11.2
4	3002P04 89V	3.00	9.7	14.2
6	3002P06 89V	6.00	12.7	17.2
8	3002P08 89V	9.00	15.7	20.2
10	3002P10 89V	12.00	18.7	23.2
12	3002P12 89V	15.00	21.7	26.2
14	3002P14 89V	18.00	24.7	29.2
16	3002P16 89V	21.00	27.7	32.2
18	3002P18 89V	24.00	30.7	35.2
20	3002P20 89V	27.00	33.7	38.2
22	3002P22 89V	30.00	36.7	41.2
24	3002P24 89V	33.00	39.7	44.2

DESCRIPTION OF ORDER NO.:

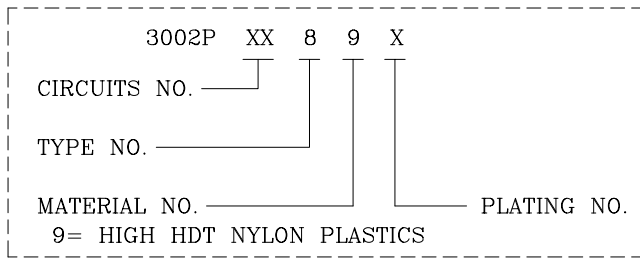

NOTES:

- MATERIAL:**
 BASE: HIGH HDT NYLON 94V-0, BLACK COLOR
 CONTACT PIN: BRASS
 SOLDER PEG: BRASS, MATTE TIN-PLATED
- MATES WITH 3000F DUAL-ROW SERIES PLUG HOUSING.
- DESCRIPTION OF COLOR CODE:**
 LEGEND: 3002PXX89X-X (-X: COLOR CODE)
 R=RED, E=BLUE, H=GRAY, M=GREEN, S=IVORY (NATURAL)
 I=BRICK RED,
- REPLACEMENT OF HALOGEN-FREE PRODUCT:**
 LEGEND: 3002PXX89X-XNH (NH: HALOGEN-FREE)
 LEGEND: 3002PXX89X-BNH (B=BLACK COLOR)
- PACKING Q'ty= 250 PCS (Embossed Tape Reel in 330 mm Dia. Panel)
- INFORMATION IN THIS DRAWING IS NOT CONSIDERED AS FINAL.

DESCRIPTION OF PLATING CODE:	
V= MATTE TIN-PLATED	A= SELECT GOLD FLASH-PLATED

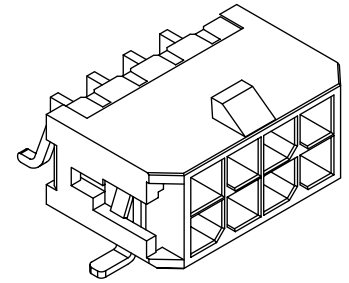
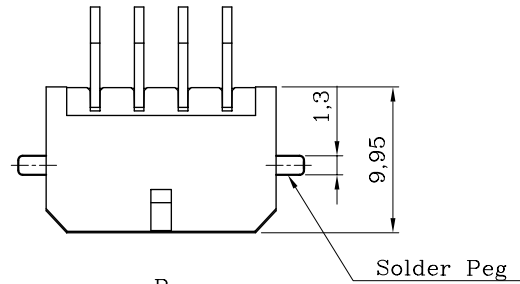

ISOMETRIC VIEW

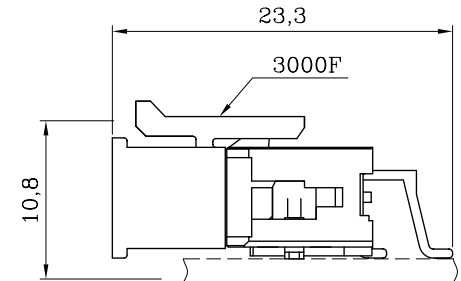
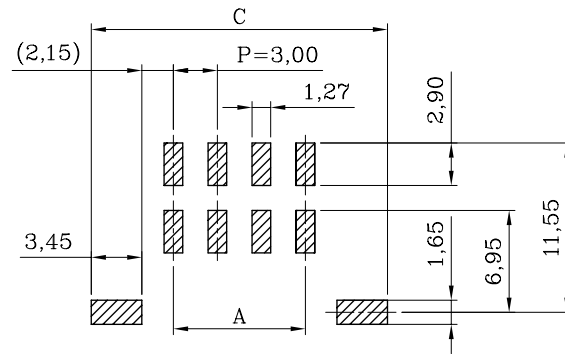
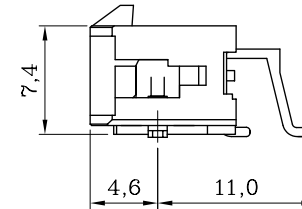
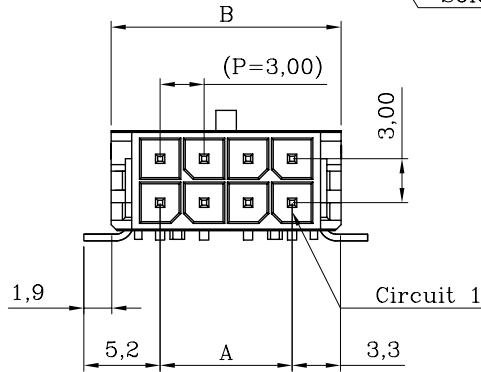

ASSEMBLY LAYOUT

P.C. BOARD LAYOUT
(COMPONENT SIDE)



GWT 850 °C Rated Sales Drawing

MATERIAL: SEE NOTES	
FINISH(COLOR): SEE NOTES	
W1	NEW RELEASE
REV.	REVISION RECORD

LANDWIN 聯盈電子股份有限公司 LANDWIN ELECTRONIC CORP.				
GENERAL TOLERANCE:	PROJECTION	SCALE	UNIT	SHEET NO.
	⊕	FREE	MM	1 / 1
	DRAWN	R.G.	DRAW NO.	
	CHECKED	J.L.Lin	(CQ) 3002PXX89X	
	APPD	H.Y.Lin	TITLE:	
	W1	NEW RELEASE	DATE 31-DEC-14'	3.00 PITCH DUAL-ROW R/A HEADER (TYPE-8)
	REV.	REVISION RECORD	DATE	